

Soldier John Cronk's Letter Describing Training Camp

See a lesson plan related to this material on the [Wisconsin Historical Society website](http://www.wisconsinhistory.org).



WISCONSIN
HISTORICAL
SOCIETY

Map "Historic Map of Camp Randall"

Drawn by Assistant Quartermaster N.B. Van Slyke

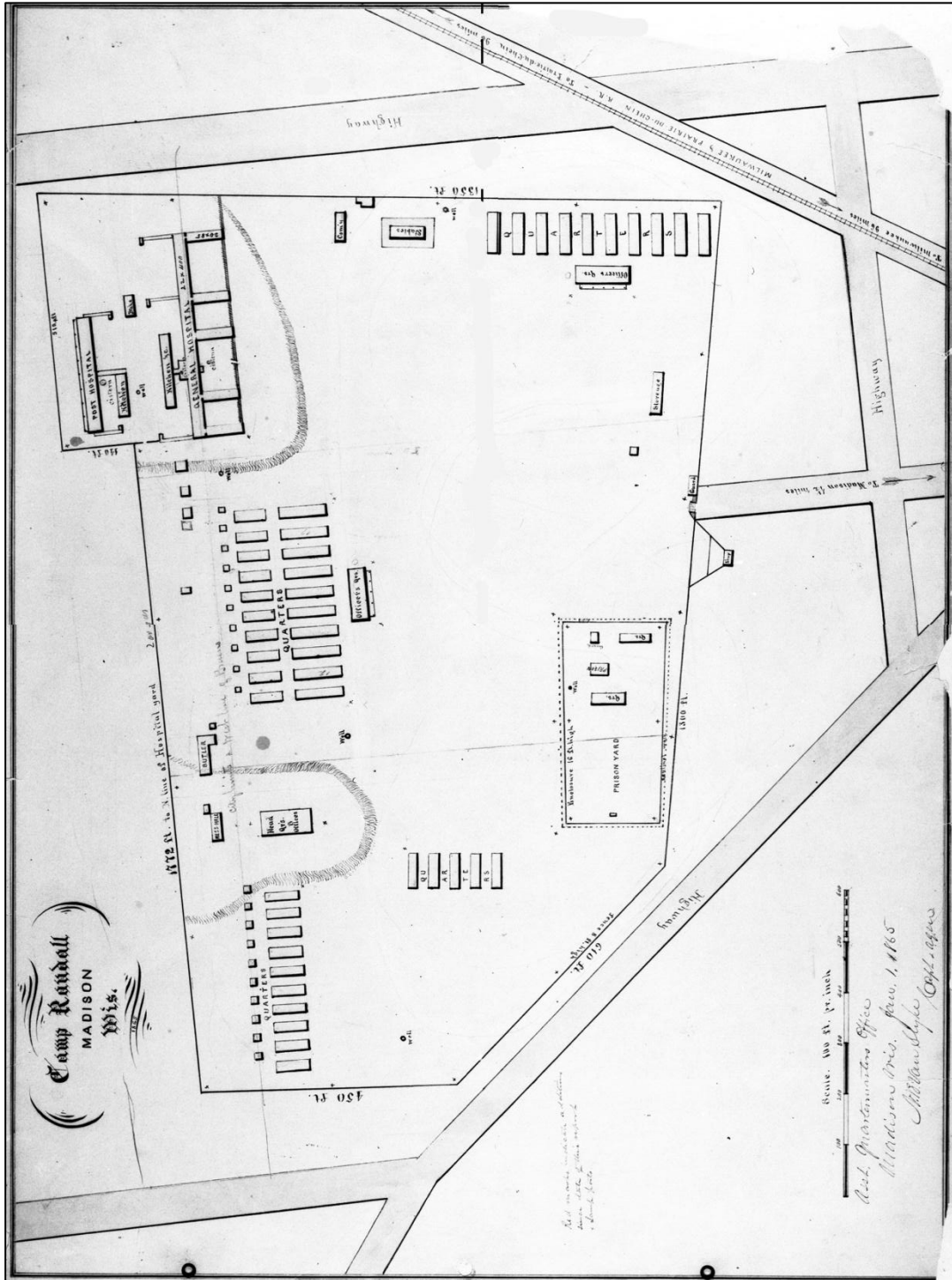

See more classroom materials and lesson plans on the Wisconsin Historical Society website.